

INDICATIVE KING POST WALL BY OTHERS
WHERE OPEN CUT & BATTER CANNOT BE
ACHIEVED

INDICATIVE KING POST WALL BY OTHERS
WHERE OPEN CUT & BATTER CANNOT BE
ACHIEVED

SHEET PILING
1: 150

- Notes:
1. THIS DRAWING IS TO BE READ IN CONJUNCTION WITH ALL RELEVANT ARCHITECTS AND ENGINEERS DRAWINGS AND SPECIFICATIONS.
 2. DO NOT SCALE THIS DRAWING. ANY AMBIGUITIES, OMISSIONS AND ERRORS ON DRAWINGS SHALL BE BROUGHT TO THE ENGINEERS ATTENTION IMMEDIATELY. ALL DIMENSIONS MUST BE CHECKED / VERIFIED ON SITE.
 3. ALL DIMENSIONS ARE IN MILLIMETRES UNLESS NOTED OTHERWISE.
 4. FOR GENERAL NOTES REFER TO DRAWINGS DR-S-00001 TO DR-S-00003

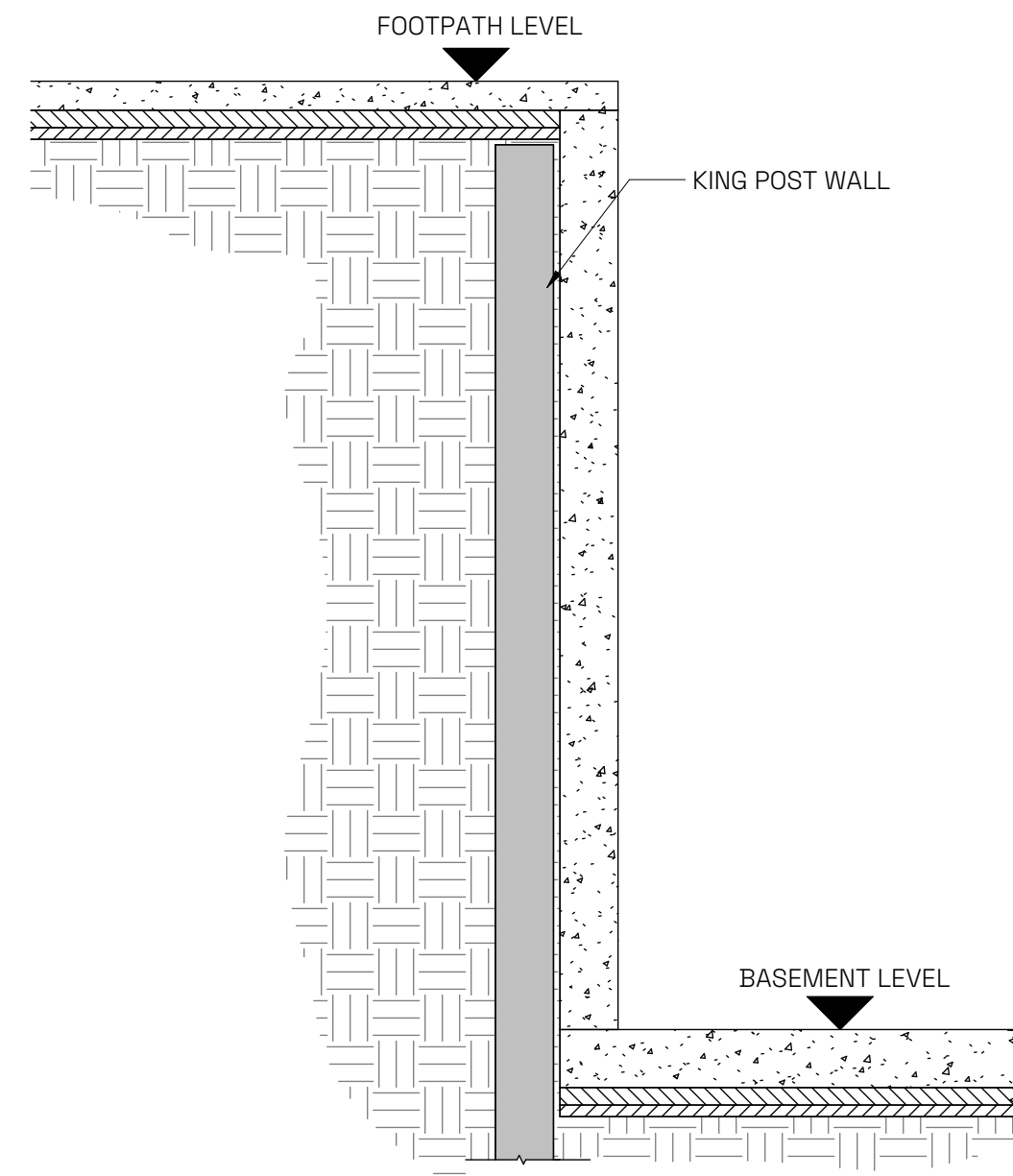

SHEET PILING SECTION
1: 25

PO1	ISSUED FOR PLANNING	AC	03.09.24
PO0	REVISED AS PER RSA COMMENTS	AC	13.08.24
REV	DESCRIPTION	BY	DATE
STATUS: INFORMATION			

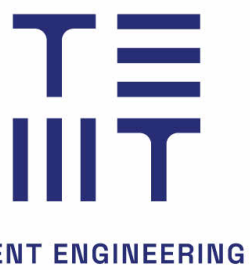

PROJECT: MERRION COMPOUND			
TITLE: KING POST WALL LAYOUT			
SCALE AT A1: As indicated	DATE: MAY 24	DRAWN: AC	CHECKED: DH
DRAWING NO: 24042-X-L00-DR-TNT-CE-3203	REVISION: P01		